

GAS BURNERS AT 2 STAGES PROGRESSIVE AND MODULATING



Burners both for housing and industrial purposes for gas at 2 stages progressive (hi-low flame) or PID fully modulating if optional modulation kit (digital type) and feeder (of temperature and pressure) are added.

Fan not included to be chosen based on technical specifications of the plant.

Available versions for natural gas or LPG (to be specified in your order). Special versions for biogas or town gas could be supplied on demand.

Gas train includes working valve, safety valve, minimum gas pressure switch, pressure filter-stabilizer and is supplied already assembled, connected and tested.

The adoption of strong metal components makes the burner durable and very reliable.

TECHNICAL DATA

MODEL		HI-GAS P350/M CE	HI-GAS P450/M CE	HI-GAS P550/M CE	HI-GAS P650/M CE
Flow-rate G20 (METANO) *	Nm ³ /h	47/140-409	58/187-526	70/235-647	117/351-760
Flow-rate G31 (G.P.L.) *	Nm ³ /h	18/54-158	22/72-203	27/91-250	45/136-294
Heat output *	Mcal/h	400/1200-3500	500/1600-4500	600/2000-5500	1000/3000-6500
Heat output *	kW	464/1390-4060	580/1850-5220	696/2325-6395	1162/3488-7558
Fuel	NATURAL GAS (second family) - GPL (third family)				
Electrical supply	1/N~230V-50Hz				
Electrical protection	IP54				

* Reference conditions: Room temperature 20°C - Atmospheric pressure 1013 mbars - Altitude 0 (sea level).

OVERALL DIMENSIONS (mm.)

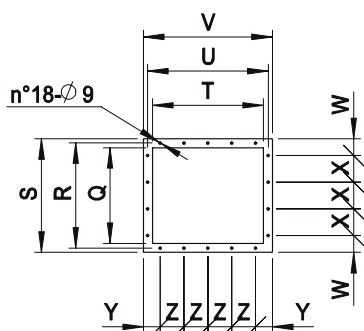

mod. HI-GAS P350/M CE - P450/M CE - P550/M CE - P650/M CE									
Q	R	S	T	U	V	W	X	Y	Z
341	375	405	395	430	460	60	95	60	85

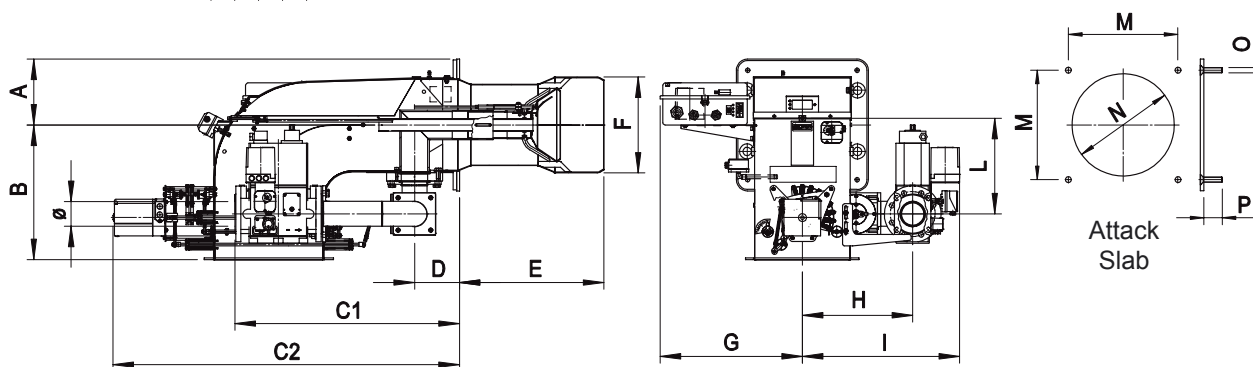

MODEL	A	B	C1	C2	D	E	F	G	H	I	L	M	N	O	P	∅	RAMP weight
HI-GAS P350/MCE DN65	235	480	515	780	160	513	340	507	393	550	317	390	360	M14	50	DN65	37 Kg
HI-GAS P350/MCE DN80	235	480	515	800	160	513	340	507	393	560	317	390	360	M14	50	DN80	47 Kg
HI-GAS P350/MCE DN100	235	480	690	840	160	513	340	507	424	600	317	390	360	M14	50	DN100	57 Kg
HI-GAS P450/MCE DN65	235	480	710	780	160	518	380	568	393	550	317	390	400	M14	50	DN65	37 Kg
HI-GAS P450/MCE DN80	235	480	750	800	160	518	380	568	393	560	317	390	400	M14	50	DN80	47 Kg
HI-GAS P450/MCE DN100	235	480	515	840	160	518	380	568	424	600	317	390	400	M14	50	DN100	57 Kg
HI-GAS P550/MCE DN65	235	480	690	780	160	518	402	568	393	550	317	390	420	M14	50	DN65	37 Kg
HI-GAS P550/MCE DN80	235	480	710	800	160	518	402	568	393	560	317	390	420	M14	50	DN80	47 Kg
HI-GAS P550/MCE DN100	235	480	750	840	160	518	402	568	424	600	317	390	420	M14	50	DN100	57 Kg
HI-GAS P650/MCE DN65	235	480	690	780	160	490	420	568	393	550	317	390	420	M14	50	DN65	37 Kg
HI-GAS P650/MCE DN80	235	480	710	800	160	490	420	568	393	560	317	390	420	M14	50	DN80	47 Kg
HI-GAS P650/MCE DN100	235	480	750	840	160	490	420	568	424	600	317	390	420	M14	50	DN100	57 Kg